



Station Road | Tivetshall St Margaret | Norwich | NR15 2ED

£1,000 PCM

DURRANTS
SINCE 1853

Key features

- Semi Detached
- Thatched
- Two Bedrooms
- Attic Room
- Off Road Parking
- Electric Heating

Description

A semi detached Grade II Listed thatched three bedroom cottage split over three floors which has been redecorated throughout including new flooring, new kitchen, shower room and downstairs cloakroom. The property has off road parking, gardens and oil fired central heating, gardens to the rear with views over countryside. Please note there a low beams and doorways.

Directions

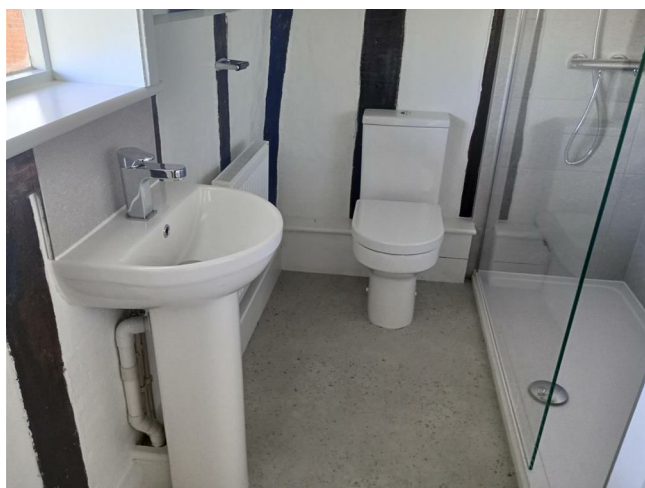



Floor plans

GROUND FLOOR
366 sq.ft. (34.0 sq.m.) approx.

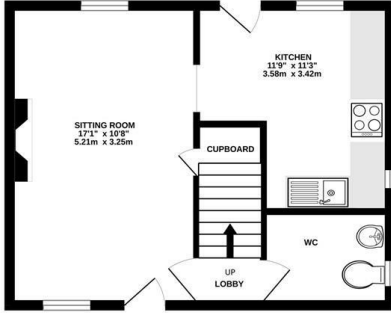

1ST FLOOR
371 sq.ft. (34.4 sq.m.) approx.

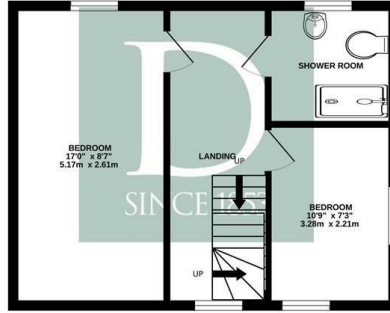

2ND FLOOR
191 sq.ft. (17.8 sq.m.) approx.

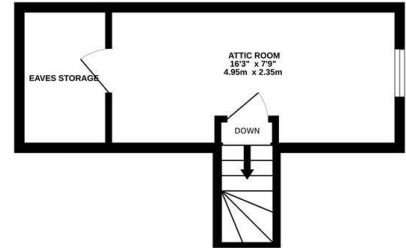

TOTAL FLOOR AREA : 928 sq.ft. (86.2 sq.m.) approx.

Whilst every attempt has been made to ensure the accuracy of the floorplan contained here, measurements of doors, windows, rooms and any other items are approximate and no responsibility is taken for any error, omission or mis-statement. This plan is for illustrative purposes only and should be used as such by any prospective purchaser. The services, systems and appliances shown have not been tested and no guarantee as to their operability or efficiency can be given.
Made with Metropix ©2026

Energy Efficiency Rating		
	Current	Potential
Very energy efficient - lower running costs		
(92 plus) A		
(81-91) B		
(69-80) C		
(55-68) D		
(39-54) E		
(21-38) F		
(1-20) G		
Not energy efficient - higher running costs		
England & Wales	EU Directive 2002/91/EC	



32-34 The Thoroughfare
Harleston
Norfolk
IP20 9AU
01379 852217
harleston@durrants.com
<https://durrants.com/>